



INSTALLATION INSTRUCTIONS FOR NEW BARN DOOR SERIES

The Barn Door Shutter Company

OVERVIEW

The Barn Door series of interior window and cabinet doors may be used in two different applications either with a single door sliding to one side or two doors meeting at the middle of the opening and sliding in opposite directions. The track installation is the same for both applications.

The critical dimension is the height of the track above the window sill. The doors need to have a minimum of 1/4" clearance above the sill to allow for ease of sliding.

In most applications, the doors are ordered wide enough to cover the side interior window casing, and long enough to cover the head casing. The track is installed on a ledger board to allow for casing thickness and stud location. For a single door, the length of the track kit is double the window width. For a pair of doors, use two kits.

The single hardware kit includes the track, two roller hangers, and related mounting screws and anchors for the rollers along with lag bolts and spacers for the track.

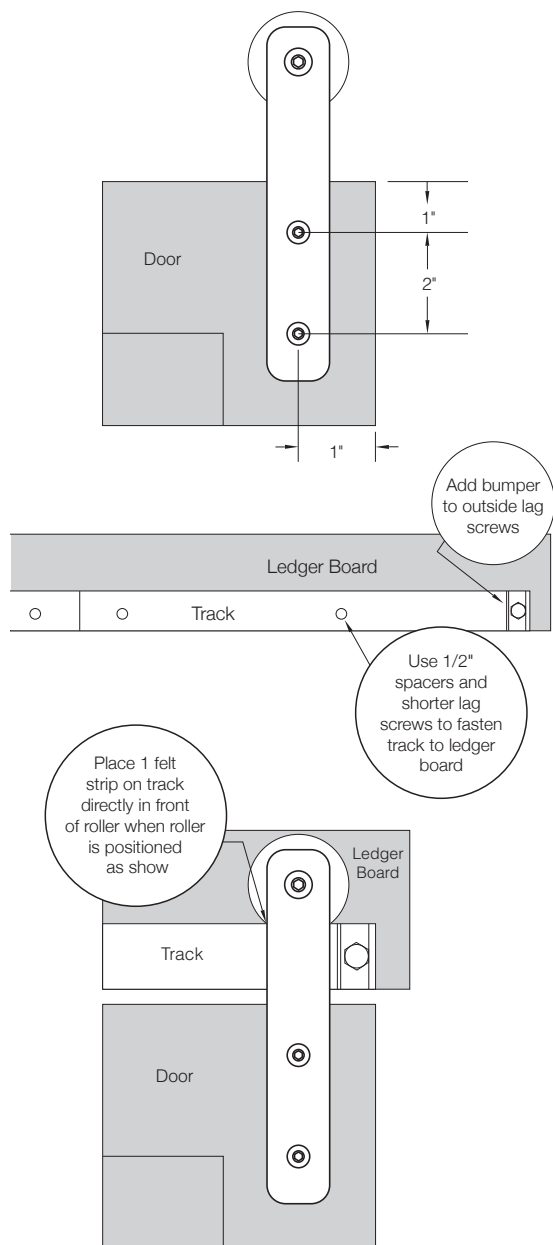

Installing hanger and rollers on door:

The Barn Door series are manufactured 1-1/8" in thickness with 2" door stiles. On the front of the door center the hanger on the stile, and mark the top pre-drilled hole 1" from top edge. Mark hole locations and drill with 3/8" drill bit.

Install the insert anchors in the drill hole on the back of the door and then attach hanger and roller to door with included screws and allen wrench.

Installing track on ledger board:

Depending on your preference, the length of the ledger board can be the overall width of the window including casing for a single door, and the overall width times two for pairs. The ledger board can be longer than these dimensions if so desired.

The Barn Door series track has two pieces for pairs, and a single length for single doors. The installation is the same for both applications. Place the track flush with the bottom edge of your pre-cut ledger board and locate all the holes.

Take care in this step as the door rollers will glide in both directions easily. Drill the holes with 1/4" drill bit. Use the shorter lag screws and 1/2" spacers provided to fasten track to ledger board. Add bumpers on the two outside lag screws before tightening.

Installing ledger board on wall:

Above the window locate the wall studs and mark at least 2, preferably 4, for ledger board support. Place a door on the window sill on 1/4" spacers, and locate bottom of roller. This will be the top of the track. Place ledger board on wall with rollers mounted on track and level. This is the most critical step in installation, and if the track is not level, the doors will not operate correctly.

Fasten ledger board at stud locations with 2" drywall screws, remove 1/4" spacers from window sill and close doors. Check operation and alignment. The doors should meet evenly when closed. Adjust hangers if necessary. Open doors and install felt strips close to rollers to keep doors in open position.